

GENERAL TECHNICAL CHARACTERISTICS 技术特性

Reference standards 参考标准	IEC 61071, IEC 60068
Dielectric 介质材料	Polypropylene film
Construction 封装结构	Dry construction, Non-inductive type
Case 外壳材料	Polyester tape wrapping; UL94V-0 resin filling
Leads 引出端	Tinned copper wire

ELECTRICAL CHARACTERISTICS 电气特性

Operating temperature 工作温度范围	- 40 to + 85 °C
Capacitance range 容量范围	0.0015 to 0.47 μF
Rated voltage range 额定电压	4KV to 15K Vdc
Capacitance tolerance 容量偏差	± 5%, ± 10%
Dissipation factor 损耗角正切	≤8×10 ⁻⁴ Measured at 1000 Hz and 20±5°C
Life expectancy 预期寿命	100,000 hours at U _{NDC} and 70 °C (Hot-spot temperature)

TEST METHODS AND PERFORMANCES 测试方法

Dielectric strength 介质强度	1.5×U _{NDC} applied to 10s at 20±5 °C
Test voltage terminal to case 端壳耐压	3KVAC/50Hz for 60s
Insulation resistance(IR*C _N) 绝缘电阻	30000s but need not exceed 30GΩ, after 1 minute of electrification at 100Vdc (20±5°C)

OUTLINE DRAWING 外形图

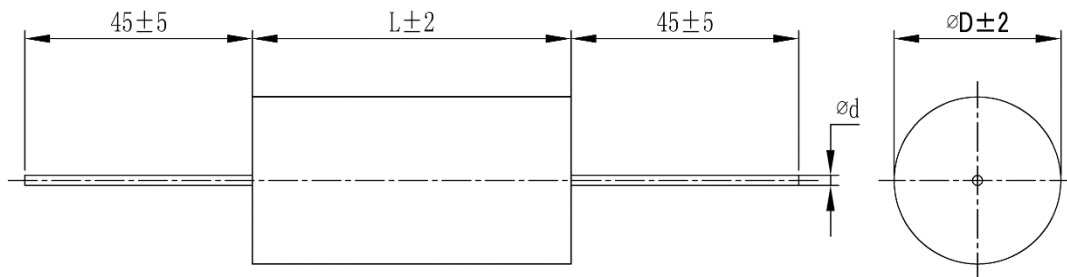

HOW TO ORDER:

<u>K1S</u>	<u>802D</u>	<u>332</u>	<u>K</u>	<u>R</u>	<u>50</u>	<u>N</u>	<u>2</u>	<u>***</u>
Series Code:	Voltage:	Capacitance:	Cap. Tol.:	Shape:	Length	Leads:	Style:	Internal
K1S:	103D: 1000Vdc	104: 0.1μF	J: ± 5%,	R: Round	L=50mm	N: Tinned	2: 2 leads	Code
AGS Series	102D: 1000Vdc	103: 0.01μf	K: ± 10%			copper wire		
		102: 0.001μF						

ELECTRICAL SPECIFICATION 规格型号参考

Unit: mm

Part Number	Capacitance (μF)	Dimension (mm)			Du/dt (v/μs)	Ipeak (A)	Urms (VAC)
		L	D	d			
U_{NDC} 4000 Vdc, Us 6000 Vdc							
K1S402D333KR44N2***	0.033	44.0	12.0	0.8	600	19.8	1600
K1S402D473KR44N2***	0.047	44.0	14.0	0.8	600	28.2	1600
K1S402D683KR44N2***	0.068	44.0	16.5	1.0	600	40.8	1600
K1S402D104KR44N2***	0.10	44.0	19.5	1.0	600	60	1600
K1S402D154KR44N2***	0.15	44.0	23.5	1.2	600	90	1600
K1S402D224KR44N2***	0.22	44.0	28.0	1.2	600	132	1600
K1S402D334KR44N2***	0.33	44.0	34.5	1.2	600	198	1600
K1S402D474KR44N2***	0.47	44.0	40.5	1.2	600	282	1600

Remark: 1. *** Internal code.

2. Customization for special specification and requirement is available.

ELECTRICAL SPECIFICATION 规格型号参考

Unit: mm

Part Number	Capacitance (μF)	Dimension (mm)			Du/dt (v/μs)	Ipeak (A)	Urms (VAC)
		L	D	d			
U_{NDC} 5000 Vdc, Us 7500 Vdc							
K1S502D223KR44N2***	0.022	44.0	12.5	0.8	700	15.4	2000
K1S502D333KR44N2***	0.033	44.0	14.5	0.8	700	23.1	2000
K1S502D473KR44N2***	0.047	44.0	17.0	1.0	700	32.9	2000
K1S502D683KR44N2***	0.068	44.0	20.0	1.0	700	47.6	2000
K1S502D104KR44N2***	0.10	44.0	24.0	1.2	700	70	2000
K1S502D154KR44N2***	0.15	44.0	29.0	1.2	700	105	2000
K1S502D224KR44N2***	0.22	44.0	35.0	1.2	700	154	2000
K1S502D334KR44N2***	0.33	44.0	42.5	1.2	700	231	2000
U_{NDC} 6000 Vdc, Us 9000 Vdc							
K1S602D333KR57N2***	0.033	57.0	14.5	0.8	900	29.7	2400
K1S602D473KR57N2***	0.047	57.0	17.0	0.8	900	42.3	2400
K1S602D683KR57N2***	0.068	57.0	19.5	1.0	900	61.2	2400
K1S602D823KR57N2***	0.082	57.0	21.5	1.2	900	73.8	2400
K1S602D104KR57N2***	0.10	57.0	23.5	1.2	900	90	2400
K1S602D154KR57N2***	0.15	57.0	28.5	1.2	900	135	2400
K1S602D224KR57N2***	0.22	57.0	34.5	1.2	900	198	2400
K1S602D334KR57N2***	0.33	57.0	41.5	1.2	900	297	2400
U_{NDC} 8000 Vdc, Us 12000 Vdc							
K1S802D332KR50N2***	0.0033	50.0	10.5	0.8	1200	3.96	3200
K1S802D472KR50N2***	0.0047	50.0	12.0	0.8	1200	5.64	3200
K1S802D682KR50N2***	0.0068	50.0	14.0	0.8	1200	8.16	3200
K1S802D822KR50N2***	0.0082	50.0	15.0	0.8	1200	9.84	3200
K1S802D103KR50N2***	0.010	50.0	16.0	1.0	1200	12	3200
K1S802D153KR50N2***	0.015	50.0	19.5	1.0	1200	18	3200
K1S802D223KR50N2***	0.022	50.0	23.0	1.2	1200	26.4	3200
K1S802D333KR50N2***	0.033	50.0	28.0	1.2	1200	39.6	3200
K1S802D473KR50N2***	0.047	50.0	33.0	1.2	1200	56.4	3200
K1S802D473KR80N2***	0.047	80.0	21.0	1.2	1100	51.7	3200
K1S802D683KR80N2***	0.068	80.0	24.5	1.2	1100	74.8	3200
K1S802D104KR80N2***	0.10	80.0	29.0	1.2	1100	110	3200
K1S802D154KR80N2***	0.15	80.0	34.5	1.2	1100	165	3200
K1S802D224KR80N2***	0.22	80.0	41.0	1.2	1100	242	3200
U_{NDC} 10000 Vdc, Us 15000 Vdc							
K1S103D472KR60N2***	0.0047	60.0	12.0	0.8	1500	7.05	4000
K1S103D682KR60N2***	0.0068	60.0	13.5	0.8	1500	10.2	4000
K1S103D103KR60N2***	0.010	60.0	16.0	1.0	1500	15	4000
K1S103D153KR60N2***	0.015	60.0	19.0	1.0	1500	22.5	4000
K1S103D223KR60N2***	0.022	60.0	23.0	1.2	1500	33	4000
K1S103D333KR60N2***	0.033	60.0	27.5	1.2	1500	49.5	4000
K1S103D473KR60N2***	0.047	60.0	32.5	1.2	1500	70.5	4000
U_{NDC} 15000 Vdc, Us 22500 Vdc							
K1S153D222KR60N2***	0.0022	60.0	12.0	0.8	2000	4.4	6000
K1S153D332KR60N2***	0.0033	60.0	14.0	0.8	2000	6.6	6000
K1S153D472KR60N2***	0.0047	60.0	16.5	1.0	2000	9.4	6000
K1S153D682KR60N2***	0.0068	60.0	19.5	1.2	2000	13.6	6000
K1S153D103KR60N2***	0.010	60.0	23	1.2	2000	20	6000
K1S153D153KR60N2***	0.015	60.0	28	1.2	2000	30	6000
K1S153D223KR60N2***	0.022	60.0	33.5	1.2	2000	44	6000

Remark: 1. *** Internal code.

2. Customization for special specification and requirement is available.