

■ GENERAL TECHNICAL CHARACTERISTICS 技术特性

Reference standards 参考标准	IEC 61071, IEC 60068
Dielectric 介质材料	Polypropylene film
Construction 封装结构	Extended metallized film with internal series connection and metallized film
Case 外壳材料	Solvent resistant plastic case. Flammability class UL94 V-0.
Leads 引出端	Tinned copper lugs for screw fixing or soldering on PCBS

■ ELECTRICAL CHARACTERISTICS 电气特性

Operating temperature 工作温度范围	- 40 to + 85 °C
Capacitance range 容量范围	1.5 to 40 μF
Rated voltage range 额定电压	330 to 700 Vdc
Capacitance tolerance 容量偏差	± 5%, ± 10%
Dissipation factor 损耗角正切	≤ 1.4 × 10 ⁻³ Measured at 1000 Hz and 20±5°C
Life expectancy 预期寿命	100,000 hours at U _{NDC} and 70 °C (Hot-spot temperature)

■ TEST METHODS AND PERFORMANCES 测试方法

Dielectric strength 介质强度	2 × U _{NDC} applied to 10s at 20±5 °C
Test voltage terminal to case 端壳耐压	3KVAC/50Hz for 60s
Insulation resistance(IR*C _N) 绝缘电阻	≥ 5000s but need not exceed 30GΩ, after 1 minute of electrification at 100Vdc (20±5°C)

■ OUTLINE DRAWING 外形图

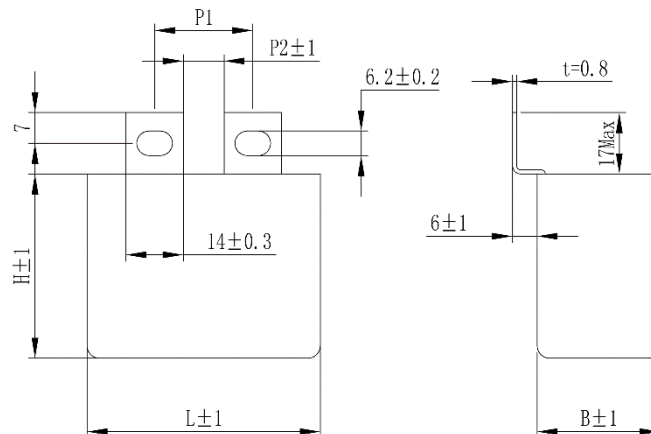

HOW TO ORDER:

K1C	701D	474	K	S	L	11	***
Series Code:	Voltage:	Capacitance:	Cap. Tol.:	Shape:	Lug Style:	Lug	Internal
K1C:	101D: 100Vdc	104: 0.1 μ F	J: \pm 5%,	S: Square	B, K, U, C, UF, CF,	Spacing	Code
AGC Series		105: 1.0 μ F	K: \pm 10%		R, G, T, TF, E, L	P2:	
		106: 10 μ F			(Refer to next page)	P2: 11mm	

ELECTRICAL SPECIFICATION 规格型号参考

Unit: mm

Part Number	Cap (μ F)	Dimension			Du/dt (v/ μ s)	Ipeak (A)	Imax @ 60°C @10KHz (A)	ESR @100KHz (m Ω)
		L	B	H				
U_{NDC} 330Vdc, Urms 200Vac, Us 500Vdc								
K1C331D685KS####	6.8	42.5	24.5	27.5	30	204	16.5	2.8
K1C331D489KS####	15	42.5	33.5	35.5	30	450	24.0	2.0
K1C331D206KS####	20	42.5	33.0	45.0	30	600	27.0	1.8
K1C331D226KS####	22	42.5	33.0	45.0	30	660	27.5	1.7
K1C331D256KS####	25	57.5	30.0	45.0	17	425	23.5	2.8
K1C331D306KS####	30	57.5	30.0	45.0	17	510	25.0	2.6
K1C331D356KS####	35	57.5	35.0	50.0	17	595	30.0	2.3
K1C331D406KS####	40	57.5	35.0	50.0	17	680	32.0	2.1
U_{NDC} 400Vdc, Urms 250Vac, Us 600Vdc								
K1C41D405KS####	4.0	42.5	24.5	27.5	40	160	15.5	3.2
K1C401D505KS####	5.0	42.5	24.5	27.5	40	200	17.0	2.8
K1C401D685KS####	6.8	42.5	33.5	35.5	40	272	22.0	2.4
K1C401D106KS####	10	42.5	33.5	35.5	40	400	24.0	2.0
K1C401D1255KS####	12.5	42.5	33.0	45.0	40	500	27.0	1.9
K1C401D156KS####	15	42.5	33.0	45.0	40	600	28.0	1.8
K1C401D206KS####	20	57.5	30.0	45.0	20	400	25.0	2.8
K1C401D226KS####	22	57.5	35.0	50.0	20	440	26.5	2.7
K1C401D256KS####	25	57.5	35.0	50.0	20	500	28.0	2.5
U_{NDC} 600Vdc, Urms 330Vac, Us 800Vdc								
K1C601D255KS####	2.5	42.5	24.5	27.5	55	137	14.5	3.8
K1C601D305KS####	3.0	42.5	24.5	27.5	55	165	15.0	3.4
K1C601D335KS####	3.3	42.5	24.5	27.5	55	182	15.5	3.3
K1C601D405KS####	4.0	42.5	33.5	35.5	55	220	21.0	2.6
K1C601D475KS####	4.7	42.5	33.5	35.5	55	259	22.0	2.4
K1C601D505KS####	5.0	42.5	33.5	35.5	55	275	22.5	2.4
K1C601D685KS####	6.8	42.5	33.0	45.0	55	374	25.0	2.2
K1C601D905KS####	9.0	42.5	33.0	45.0	55	495	27.0	1.9
K1C601D106KS####	10	57.5	30.0	45.0	30	300	22.0	3.7
K1C601D1255KS####	12.5	57.5	35.0	50.0	30	375	24.0	3.4
K1C601D156KS####	15	57.5	35.0	50.0	30	450	25.5	3.0
U_{NDC} 700Vdc, Urms 400Vac, Us 1000Vdc								
K1C701D155KS####	1.5	42.5	24.5	27.5	70	105	13.5	4.6
K1C701D205KS####	2.0	42.5	24.5	27.5	70	140	14.5	3.8
K1C701D225KS####	2.2	42.5	33.5	35.5	70	175	19.0	3.3
K1C701D305KS####	3.0	42.5	33.5	35.5	70	210	20.0	3.0
K1C701D335KS####	3.3	42.5	33.5	35.5	70	231	20.5	2.9
K1C701D405KS####	4.0	42.5	33.0	45.0	70	280	23.5	2.5
K1C701D475KS####	4.7	42.5	33.0	45.0	70	329	25.0	2.2
K1C701D505KS####	5.0	42.5	33.0	45.0	70	350	25.5	2.9
K1C701D685KS####	6.8	57.5	30.0	45.0	40	272	21.5	3.8
K1C701D805KS####	8.0	57.5	35.0	50.0	40	320	24.0	3.5
K1C701D905KS####	9.0	57.5	35.0	50.0	40	360	25.0	3.2

Remark: 1. ## Lug style and P2; *** Internal code.

2. Customization for special specification and requirement is available.

Lug Dimensions for Plastic Case

Unit: mm

These Lug dimensions suitable for style: B, K, U, C, UF, CF, R, G, T, TF, E and L.

Chose the correct styles according to your assemble way.

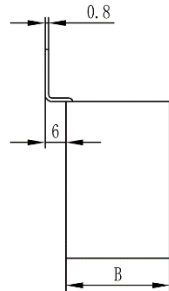
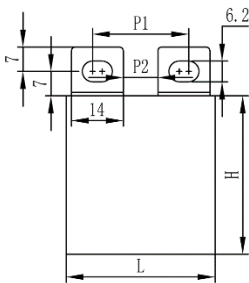

Style B

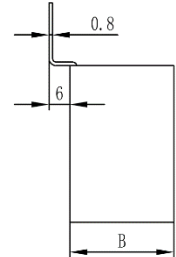
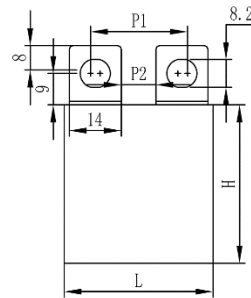

Style K

Fixing pitch and distance between lugs: Style B, Style K

Style	B					K				
	L	P2	P1	P2	P1	Output	P2	P1	P2	P1
42.5	11	23-28	8	20-25	M6	11	24-26	8	21-23	M8
57.5	11	23-28	24	36-41	M6	11	24-26	24	37-39	M8

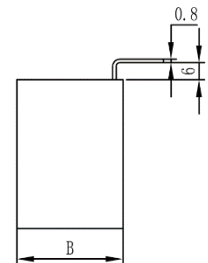
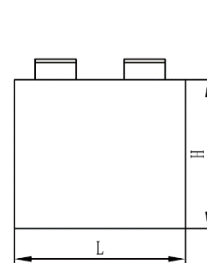
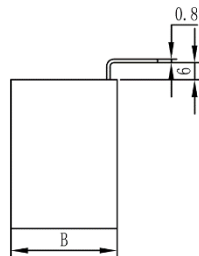
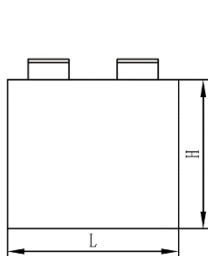

Style U

Style C

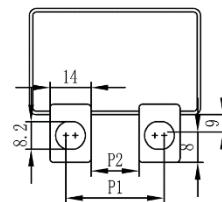
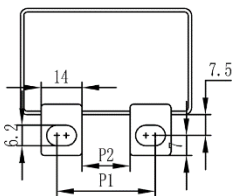

Style	U					C				
	L	P2	P1	P2	P1	Output	P2	P1	P2	P1
42.5	11	23-28	8	20-25	M6	11	24-26	8	21-23	M8
57.5	11	23-28	24	36-41	M6	11	24-26	24	37-39	M8

■ Lug Dimensions for Plastic Case

Unit: mm

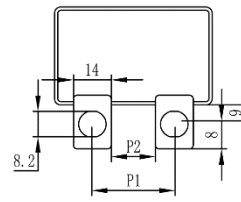
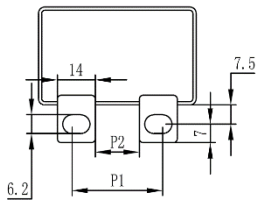
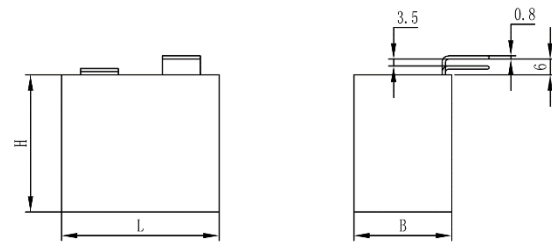
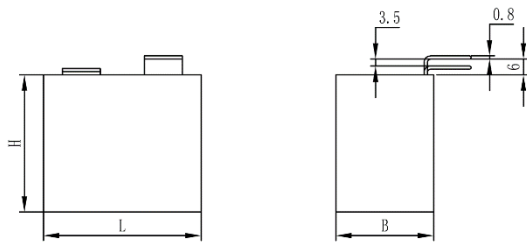

Style UF

Style CF

Style	UF					CF				
	P2	P1	P2	P1	Output	P2	P1	P2	P1	Output
42.5	11	23-28	8	20-25	M6	11	24-26	8	21-23	M8
57.5	11	23-28	24	36-41	M6	11	24-26	24	37-39	M8

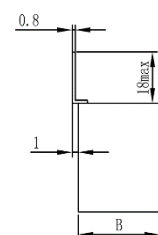
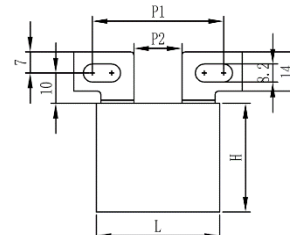
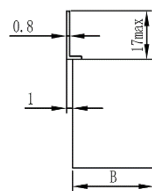
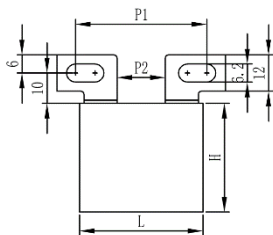

Style R

Style G

Style	R							G						
	P2	P1	P2	P1	P2	P1	Output	P2	P1	P2	P1	P2	P1	Output
42.5	11	29-39	15	33-45			M6	8	33-42	15	40-49			M8
57.5	11	29-39	15	33-45	28	46-58	M6	15	40-49	24	49-58	28	53-62	M8

■ Lug Dimensions for Plastic Case

Unit: mm

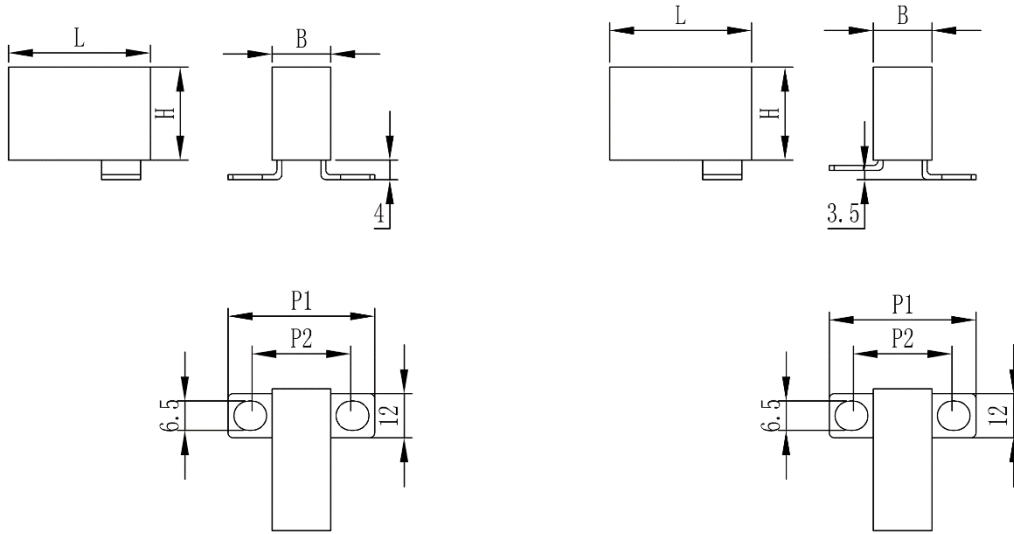

Style T

Style TF

Style	T			TF		
	B	P2	P1	Output	P2	P1
15	30	43	M6	30	43	M6
17	32	45	M6	32	45	M6

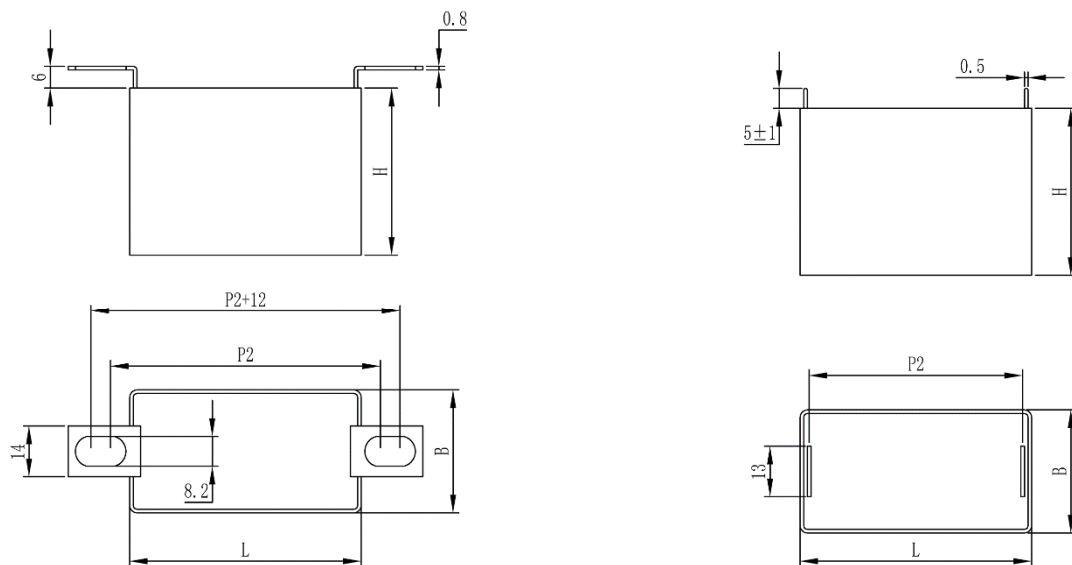

Style E

Style L

Style	E	L
L	P2	P2
42.5	51	37.5
57.5	65	52.5