

### GENERAL TECHNICAL CHARACTERISTICS 技术特性

Reference standards 参考标准	IEC 61071, IEC 60068
Dielectric 介质材料	Polypropylene film
Construction 封装结构	Dry construction, Non-inductive type
Case 外壳材料	Polyester tape wrapping; UL94V-0 resin filling
Output 引出端	Threaded insert M6 or M8

### ELECTRICAL CHARACTERISTICS 电气特性

Operating temperature 工作温度范围	- 40 to + 85 °C
Capacitance range 容量范围	0.5 to 12 $\mu$ F
Rated voltage range 额定电压	400 to 700 Vac
Capacitance tolerance 容量偏差	$\pm 5\%$ , $\pm 10\%$
Dissipation factor 损耗角正切	$\leq 5 \times 10^{-4}$ Measured at 1000 Hz and 20 $\pm 5^\circ$ C
Life expectancy 预期寿命	100,000 hours at $U_N$ and 70 °C (Hot-spot temperature)

### TEST METHODS AND PERFORMANCES 测试方法

Dielectric strength 介质强度	1.5 $\times$ Urms (AC) applied to 10s at 20 $\pm 5^\circ$ C
Test voltage terminal to case 端壳耐压	3KVAC/50Hz for 60s
Insulation resistance(IR $\times$ C <sub>N</sub> ) 绝缘电阻	30000s but need not exceed 30G $\Omega$ , after 1 minute of electrification at 100Vdc (20 $\pm 5^\circ$ C)

### OUTLINE DRAWING 外形图

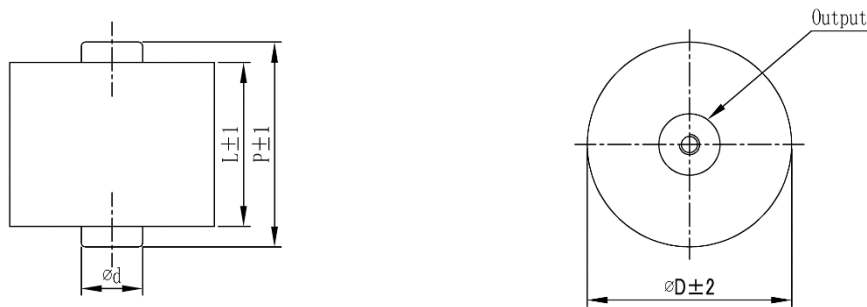

Style S

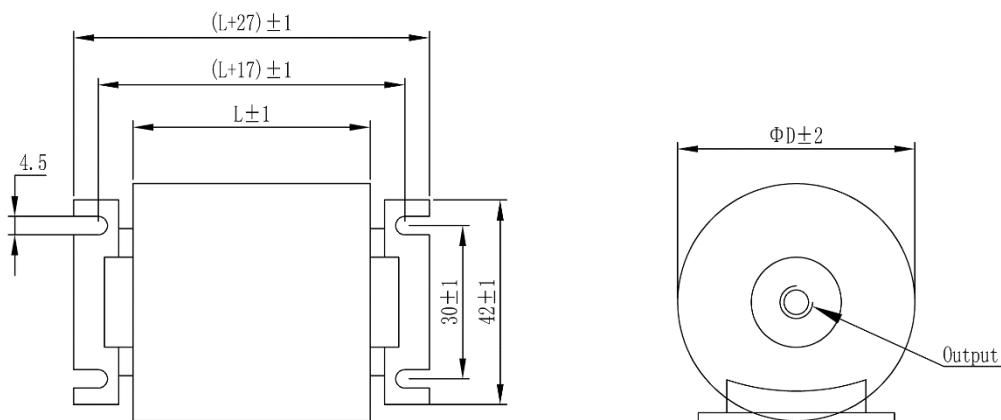

Style A

Output	M6*8	M8*8
d	15mm	18mm
Max Torque	4.5 N.M	8.5 N.M

### HOW TO ORDER:

<u>  K1R  </u>	<u>  701A  </u>	<u>  105  </u>	<u>  K  </u>	<u>  R  </u>	<u>  F  </u>	<u>  6  </u>	<u>  S  </u>	<u>  ***  </u>
Series Code:	Voltage:	Capacitance:	Cap. Tol.:	Shape:	Output:	Output Size:	Style:	Internal
K1R:	101A: 100Vac	106: 10μF	J: ± 5%,	R: Round	F: Thread	6: M6*8	S, A,	Code
AGR Series	102A: 1000Vac	105: 1.0μF	K: ± 10%			8: M8*8		

### ELECTRICAL SPECIFICATION 规格型号参考

Unit: mm

Part Number	Capacitance (μF)	Dimension				Du/dt (v/μs)	Imax@60°C 10KHz(A)	ESR@10KHz (mΩ)	Rth (K/W)
		D	L	P	Output				
<b>Urms 400Vac, U<sub>NDC</sub> 1000Vdc, Upeak 565V</b>									
K1R401A155KRF##***	1.5	44.0	37.0	48	M6*8	540	43	2.0	11.0
K1R401A305KRF##***	3.0	54.0	40.0	52	M6*8	490	57	1.8	7.4
K1R401A405KRF##***	4.0	62.0	40.0	52	M6*8	490	66	1.8	6.0
K1R401A605KRF##***	6.0	76.0	40.0	52	M8*8	490	83	1.7	4.3
K1R401A705KRF##***	7.0	82.0	40.0	52	M8*8	490	90	1.7	3.8
K1R401A126KRF##***	12	82.0	50.0	63	M8*8	410	96	1.8	3.2
<b>Urms 500Vac, U<sub>NDC</sub> 1200Vdc, Upeak 710V</b>									
K1R501A105KRF##***	1.0	43.0	37.0	48	M6*8	660	40	2.7	11.4
K1R501A205KRF##***	2.0	49.0	40.0	52	M6*8	570	49	2.3	8.6
K1R501A305KRF##***	3.0	60.0	40.0	52	M6*8	570	62	1.9	6.4
K1R501A405KRF##***	4.0	59.0	40.0	52	M8*8	570	73	1.9	5.1
K1R501A505KRF##***	5.0	76.0	40.0	52	M8*8	570	82	1.8	4.3
K1R501A605KRF##***	6.0	83.0	40.0	52	M8*8	570	91	1.8	3.7
K1R501A106KRF##***	10	84.0	50.0	63	M8*8	470	95	2.5	3.2
<b>Urms 700Vac, U<sub>NDC</sub> 2000Vdc, Upeak 990V</b>									
K1R701A504KRF##***	0.50	42.0	37.0	48	M6*8	1190	36	2.7	11.7
K1R701A105KRF##***	1.0	54.0	40.0	52	M6*8	1190	50	2.5	7.5
K1R701A155KRF##***	1.5	66.0	40.0	52	M8*8	1190	64	2.3	5.5
K1R701A205KRF##***	2.0	76.0	40.0	52	M8*8	1190	77	2.0	4.4
K1R701A255KRF##***	2.5	85.0	40.0	52	M8*8	1190	87	1.9	3.6
K1R701A405KRF##***	4.0	84.0	50.0	63	M8*8	840	87	2.3	3.2

Remark: 1. ## Output size and style; \*\*\* Internal code.

2. Customization for special specification and requirement is available.