

### GENERAL TECHNICAL CHARACTERISTICS 技术特性

Reference standards 参考标准	IEC 61071, IEC 60068
Dielectric 介质材料	Polypropylene film
Construction 封装结构	Extended double side metallized carrier film with internal series connection and metallized film
Case 外壳材料	Solvent resistant plastic case with resin sealing. Flame retardant execution (UL94V-0).
Leads 引出端	Tinned copper wire

### ELECTRICAL CHARACTERISTICS 电气特性

Operating temperature 工作温度范围	- 40 to + 85 °C
Capacitance range 容量范围	0.001 to 1.5 μF
Rated voltage range 额定电压	630 to 2000 Vdc
Capacitance tolerance 容量偏差	± 5%, ± 10%
Dissipation factor 损耗角正切	≤5×10 <sup>-4</sup> Measured at 100 Hz and 20±5°C
Life expectancy 预期寿命	100,000 hours at U <sub>NDC</sub> and 70 °C (Hot-spot temperature)

### OUTLINE DRAWING 外形图

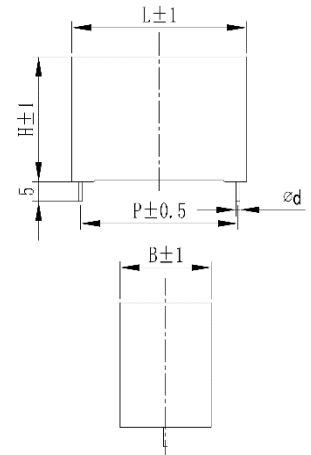

### TEST METHODS AND PERFORMANCES 测试方法

Dielectric strength 介质强度	1.5×U <sub>NDC</sub> applied to 10s at 20±5 °C
Test voltage terminal to case 端壳耐压	3KVAC/50Hz for 10s
Insulation resistance(IR*C <sub>N</sub> ) 绝缘电阻	30000s but need not exceed 30GΩ, after 1 minute of electrification at 100VDC (20±5°C)

### HOW TO ORDER:

<u>K8L</u>	<u>102D</u>	<u>474</u>	<u>K</u>	<u>S</u>	<u>N</u>	<u>2</u>	<u>P</u>	<u>***</u>
Series Code:	Voltage:	Capacitance:	Cap. Tol.:	Shape:	Leads:	Style:	Lead Space:	Internal Code
K8L:	101D: 100Vdc	104: 0.1μF	J: ± 5%,	S: square	N: Tinned copper wire	2: 2 Pins	H: 15mm T: 22.5mm V: 27.5mm F: 37.5mm	
ASL Series	102D: 1000Vdc	103: 0.01μF	K: ± 10%					

### ELECTRICAL SPECIFICATION 规格型号参考

Unit: mm

Part Number	Capacitance (μF)	Dimension					Du/dt (v/μs)
		L	B	H	P	d	
<b>U<sub>NDC</sub> 630Vdc, Urms 400Vac</b>							
K8L631D103KSN2H***	0.01	18.0	5.0	11.0	15.0	0.8	3300
K8L631D153KSN2H***	0.015	18.0	5.0	11.0	15.0	0.8	3300
K8L631D223KSN2H***	0.022	18.0	6.0	12.0	15.0	0.8	3300
K8L631D333KSN2H***	0.033	18.0	7.5	13.5	15.0	0.8	3300
K8L631D473KSN2H***	0.047	18.0	10.0	16.0	15.0	0.8	3300
K8L631D473KSN2T***	0.047	26.5	6.0	15.0	22.5	0.8	2050
K8L631D683KSN2T***	0.068	26.5	7.0	16.0	22.5	0.8	2050
K8L631D104KSN2T***	0.10	26.5	8.5	17.0	22.5	0.8	2050
K8L631D154KSN2T***	0.15	26.5	11.0	20.0	22.5	0.8	2050
K8L631D154KSN2V***	0.15	31.0	11.0	20.0	27.5	0.8	1500
K8L631D224KSN2V***	0.22	31.0	13.0	22.0	27.5	0.8	1500
K8L631D334KSN2V***	0.33	31.0	15.0	24.5	27.5	0.8	1500
K8L631D474KSN2V***	0.47	31.0	18.0	33.0	27.5	1.0	1500
K8L631D474KSN2F***	0.47	42.5	17.0	28.0	37.5	1.0	950
K8L631D684KSN2V***	0.68	31.0	18.0	33.0	27.5	1.0	1500
K8L631D684KSN2F***	0.68	42.5	17.0	28.0	37.5	1.0	950
K8L631D105KSN2F***	1.0	42.5	22.0	30.0	37.5	1.0	950
K8L631D155KSN2F***	1.5	42.5	28.0	37.0	37.5	1.0	950
<b>U<sub>NDC</sub> 1000Vdc, Urms 600Vac</b>							
K8L102D472KSN2H***	0.0047	18.0	5.0	11.0	15.0	0.8	5500
K8L102D682KSN2H***	0.0068	18.0	5.0	11.0	15.0	0.8	5500
K8L102D103KSN2H***	0.01	18.0	6.0	12.0	15.0	0.8	5500
K8L102D153KSN2H***	0.015	18.0	7.5	13.5	15.0	0.8	5500
K8L102D223KSN2H***	0.022	18.0	8.5	14.5	15.0	0.8	5500

Remark: 1. \*\*\* Internal code.

2. Customization for special specification and requirement is available.

### ELECTRICAL SPECIFICATION 规格型号参考

Unit: mm

Part Number	Capacitance (μF)	Dimension					Du/dt (v/μs)
		L	B	H	P	d	
<b>U<sub>NDC</sub> 1000Vdc, Urms 600Vac</b>							
K8L102D223KSN2T***	0.022	26.5	6.0	15.0	22.5	0.8	2600
K8L102D333KSN2T***	0.033	26.5	7.0	16.0	22.5	0.8	2600
K8L102D473KSN2T***	0.047	26.5	8.5	17.0	22.5	0.8	2600
K8L102D683KSN2T***	0.068	26.5	10.0	18.5	22.5	0.8	2600
K8L102D104KSN2T***	0.10	26.5	13.0	22.0	22.5	0.8	2600
K8L102D104KSN2V***	0.10	31.0	11.0	20.0	27.5	0.8	1850
K8L102D154KSN2V***	0.15	31.0	13.0	22.0	27.5	0.8	1850
K8L102D154KSN2V***	0.15	31.0	13.0	22.0	27.5	0.8	1850
K8L102D224KSN2V***	0.22	31.0	15.0	24.5	27.5	0.8	1850
K8L102D334KSN2V***	0.33	31.0	18.0	33.0	27.5	1.0	1850
K8L102D334KSN2F***	0.33	42.5	15.0	26.0	37.5	1.0	1200
K8L102D474KSN2F***	0.47	42.5	17.0	28.0	37.5	1.0	1200
K8L102D684KSN2F***	0.68	42.5	22.0	30.0	37.5	1.0	1200
K8L102D105KSN2F***	1.0	42.5	28.0	37.0	37.5	1.0	1200
<b>U<sub>NDC</sub> 1600Vdc, Urms 650Vac</b>							
K8L162D222KSN2H***	0.0022	18.0	5.0	11.0	15.0	0.8	7500
K8L162D332KSN2H***	0.0033	18.0	6.0	12.0	15.0	0.8	7500
K8L162D472KSN2H***	0.0047	18.0	7.5	13.5	15.0	0.8	7500
K8L162D682KSN2H***	0.0068	18.0	8.5	14.5	15.0	0.8	7500
K8L162D103KSN2H***	0.01	18.0	10.0	16.0	15.0	0.8	7500
K8L162D103KSN2T***	0.01	26.5	6.0	15.0	22.5	0.8	3800
K8L162D153KSN2T***	0.015	26.5	7.0	16.0	22.5	0.8	3800
K8L162D223KSN2T***	0.022	26.5	8.5	17.0	22.5	0.8	3800
K8L162D333KSN2T***	0.033	26.5	10.0	18.5	22.5	0.8	3800
K8L162D473KSN2T***	0.047	26.5	13.0	22.0	22.5	0.8	3800
K8L162D473KSN2V***	0.047	31.0	11.0	20.0	27.5	0.8	2700
K8L162D683KSN2V***	0.068	31.0	13.0	22.0	27.5	0.8	2700
K8L162D104KSN2V***	0.10	31.0	17.0	28.0	27.5	0.8	2700
K8L162D154KSN2V***	0.15	31.0	18.0	33.0	27.5	1.0	2700
K8L162D154KSN2F***	0.15	42.5	15.0	26.0	37.5	1.0	1700
K8L162D224KSN2F***	0.22	42.5	17.0	28.0	37.5	1.0	1700
K8L162D334KSN2F***	0.33	42.5	22.0	30.0	37.5	1.0	1700
K8L162D474KSN2F***	0.47	42.5	28.0	37.0	37.5	1.0	1700
<b>U<sub>NDC</sub> 2000Vdc, Urms 700Vac</b>							
K8L202D102KSN2H***	0.0010	18.0	5.0	11.0	15.0	0.8	9000
K8L202D152KSN2H***	0.0015	18.0	5.0	11.0	15.0	0.8	9000
K8L202D222KSN2H***	0.0022	18.0	6.0	12.0	15.0	0.8	9000
K8L202D332KSN2T***	0.0033	26.5	6.0	15.0	22.5	0.8	6200
K8L202D472KSN2T***	0.0047	26.5	6.0	15.0	22.5	0.8	6200
K8L202D682KSN2H***	0.0068	18.0	10.0	16.0	15.0	0.8	9000
K8L202D682KSN2T***	0.0068	26.5	6.0	15.0	22.5	0.8	6200
K8L202D103KSN2T***	0.01	26.5	8.5	17.0	22.5	0.8	6200
K8L202D153KSN2T***	0.015	26.5	10.0	18.5	22.5	0.8	6200
K8L202D223KSN2T***	0.022	26.5	13.0	22.0	22.5	0.8	6200
K8L202D223KSN2V***	0.022	31.0	11.0	20.0	27.5	0.8	4200
K8L202D333KSN2V***	0.033	31.0	13.0	22.0	27.5	0.8	4200
K8L202D473KSN2V***	0.047	31.0	15.0	24.5	27.5	0.8	4200
K8L202D683KSN2V***	0.068	31.0	14.0	28.0	27.5	0.8	4200
K8L202D104KSN2V***	0.10	31.0	18.0	33.0	27.5	1.0	4200
K8L202D104KSN2F***	0.10	42.5	15.0	26.0	37.5	1.0	2600
K8L202D154KSN2F***	0.15	42.5	22.0	30.0	37.5	1.0	2600
K8L202D224KSN2F***	0.22	42.5	28.0	37.0	37.5	1.0	2600
K8L202D334KSN2F***	0.33	42.5	28.0	37.0	37.5	1.0	2600

Remark: 1. \*\*\* Internal code.

2. Customization for special specification and requirement is available.